

FOR SAILORS
ONLY SINCE
1974

solaris*POWER*

DAL 1974 PER CHI NAVIGA



COUPÉ & FLYBRIDGE RANGE

S
O
L
A
R
I
S

P
O
W
E
R

SOLARIS: SINCE 1974
QUALITY, SEAWORTHINESS
AND ELEGANCE



The boatyard's reputation, founded in Aquileia more than 50 years ago, is better known among German, Swiss and Austrian yachtsmen than it is in Italy.

Right from the beginning, the company's philosophy has been the building seaworthy, solid and secure sailing boats to the highest quality standards, capable of challenging the prestigious Scandinavian and Dutch yacht builders. Fittingly, Solaris claims that our yachts are also: "Built for mariners".

Its volume and revenues increased fivefold in just a few years and

today it is the European leader in the category of top-class sailing boats from 50' to 110'. There are not many boatyards left today, who can combine leading-edge technology with traditional craftsmanship of detail and finishing as Solaris Yachts does.

Since 2008 Solaris also operates a production unit dedicated to motoryachts from 44' to 100', including five 90' luxury displacement motoryachts for an internationally renowned brand.

This facility is now the builder of the new Solaris Power range, to the same exacting quality standards of Solaris sailboats.

TRADITIONAL CRAFTSMANSHIP

There are not many boatyards left today, that can combine leading-edge technology with traditional craftsmanship of details and finishing as Solaris Yachts does.



THE LOBSTER BOAT HERITAGE

Solaris was among the first in Europe to build a lobster boat, the 47-foot Express Cruiser, by Bruce King, designer of the famous American Hinckley line.



SEA PERFORMANCE HAS ALWAYS BEEN OUR FIRST PRIORITY THIS IS WHERE WE INVEST OUR BEST RESOURCES

SMOOTH SAILING THROUGH THE WAVES AND A DRY DECK IN CHOPPY SEAS

The sharp shape of the bow and the pronounced flare, softens the passage through the waves and keeps the deck dry also in choppy seas.

GREAT STABILITY WHILE CRUISING AND AT ANCHOR

The hull shape guarantees safety, great stability and comfort when cruising and at anchor, without the need for stabilizers.



LOW FUEL CONSUMPTION RESULTING IN EXCELLENT RANGE AND REDUCED CO₂ EMISSIONS

The advanced studies on the hydrodynamics of the hull and the correct balance of weights ensure low fuel consumption, resulting in excellent range and reduced CO₂ emissions.

EFFICIENT CRUISING BOTH IN DISPLACEMENT AND IN PLANING MODE

Unlike ordinary boats with planing hulls, Solaris Power are capable to cruise steadily and without roll even in displacement mode.



THE LATEST PROPULSION TECHNOLOGY

Solaris Power yachts feature cutting-edge propulsion working in synergy with the shape of the hull. This is the outcome of intense collaboration between Victory Design and Volvo Penta. Since 2005 Brunello Acampora has been studying shapes that are optimised for the

IPS, including 'azimuth pods' for planing hulls; having found they generate huge performance improvements. Moreover, the compactness of the propulsion apparatus yields a noticeable increase of living space: the interiors of these boats compare favourably with much bigger

yachts, and make the tender easy to stow, launch and haul.



EASY DOCKING THANKS TO THE JOYSTICK

Docking manoeuvres are simplified thanks to the joystick and the azimuth pods, even with a single person at the controls.



LOW NOISE LEVEL AND ZERO VIBRATIONS

The absence of the rotating masses of the shaft line and the engine exhausts in the propeller pods ensure absence of vibrations and low noise.

SPACIOUS AND WELL VENTILATED ENGINE ROOM

Offering easy access to the engine itself and to the other systems.



INNOVATIONS FOR MORE ON-BOARD COMFORT

WALKAROUND

The decks of all models include lateral walkways that afford easy and safe movement from bow to stern.



VERY LARGE SUNBEDS

All Solaris Power have the bow sunbed. Open models also offer an aft sundeck.



TENDER GARAGE

Under the aft opening sundeck there is a large garage that can be used for the tender and various water toys.



HYDRAULIC GANGWAY

The hydraulic gangway turns into a comfortable swim ladder.



LAYOUT IN MULTIPLE VERSIONS

The internal and external layouts are available in several versions to suit the tastes and needs of owners.





COUPÉ & FLYBRIDGE RANGE

48

LOBSTER

P. 11

FLYBRIDGE

P. 39

52

COUPÉ

P. 19

60

COUPÉ

P. 31

48

SOLARIS POWER 48 LOBSTER

A NEW TAKE ON THE TRADITIONAL
LOBSTER BOAT, WITH ALL ITS FEATURES
OF SEAWORTHINESS, FUNCTIONALITY AND
SAFETY.

L
O
B
S
T
E
R

- 11 -

48









MAIN DECK

Version A



MAIN DECK

Version B



LOWER DECK

Version A

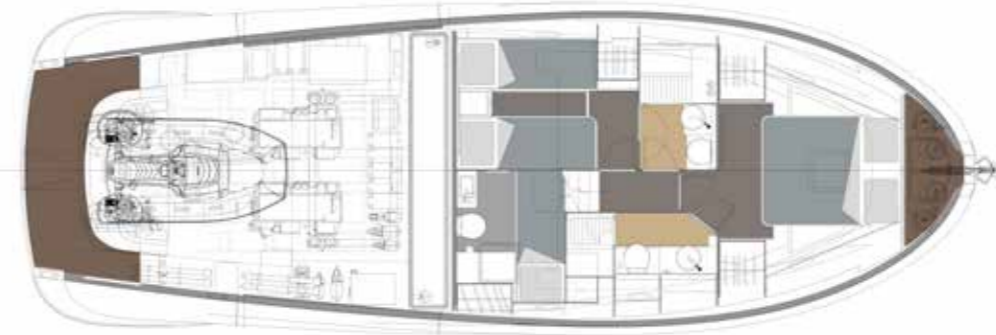

LOWER DECK

Version B



LOWER DECK

Version C



48 LOBSTER

TECHNICAL SPECIFICATIONS

LENGTH OVERALL	14,86 m / 48'74"
WATER LINE LENGTH	13,40 m / 43'95"
BEAM	4,87 m / 15'97"
DRAFT	1,05 m / 3'44"
APPROX. LIGHT DISPLACEMENT	14.750 kg / 32,518 lbs
APPROX. LOAD DISPLACEMENT	17.550 kg / 38,691 lbs
FUEL CAPACITY	1.500 L / 396 US gal
WATER CAPACITY	430 L / 114 US gal
ENGINES	2 x Volvo Penta D6 IPS 600 320 kW / 435 hp 3500 rpm 2 x Volvo Penta D6 IPS 650 353 kW / 480 hp 3800 rpm
MAX SPEED	28 kn - IPS 600 / 32 kn - IPS 650
CRUISING SPEED	20 kn - IPS 600 / 24 kn - IPS 650
CABINS	1/2
BATHROOMS	1 + 1
MAX PERSONS CAPACITY	12
DESIGN	Brunello Acampora / Victory Design Cav. Norberto Ferretti Solaris Power Design Team

52

THE NEW 52 COUPÉ

SOLARIS 52' COUPÉ,
GREAT SEAWORTHINESS AND
CLASSIC, UNMISTAKABLE ELEGANCE

C
O
U
P
É

52



GREAT SEAWORTHINESS AND CLASSIC, UNMISTAKABLE ELEGANCE

These are the key features that define the Solaris Power range since its beginnings.

SAFETY AND COMFORT WHEN AT SEA

Thanks to the deep V hull and accurate balancing of weight the boat sails smoothly through the waves. The walkaround guarantees free and safe movement even in choppy seas.

GREAT EASE ON DECK

Extensive living area with direct access to the kitchen, wide cockpit and a generous sundeck astern.

GREAT EASE BELOW DECK

Three double cabins and two bathrooms with enclosed shower and tender garage. Unique roominess for such a sporting boat.

THE ROOMIEST INTERIOR
FOR A 52-FOOTER



LOWER DECK
Version A (standard)



LOWER DECK
Version B (optional)

EXTENSIVE LIVING AREA. THE KITCHEN IS
EQUIPPED WITH A HOME-LIKE WORKING
SURFACE.

LARGE COCKPIT WITH SUNDECK AND
DINING AREA IN COMMUNICATION WITH
THE GALLEY







52

THE MAIN COMFORTS ONBOARD

WALKAROUND

The deck includes lateral walkways that afford easy and safe movement from bow to stern when at sea.

TENDER GARAGE

Under the aft opening sundeck there is a large garage that can fit a water-jet tender and various water toys.

TENDER LIFT STERN PLATFORM

It can be used during all nautical activities on board: lifting and launching a tender, a jet-ski or sea bobs, as well as a swimming deck.

HYDRAULIC GANGWAY

The hydraulic gangway turns into a comfortable swim ladder.



MAIN DECK



LOWER DECK

Version A (standard)



LOWER DECK

Version B (optional)

52 COUPÉ

TECHNICAL SPECIFICATIONS

LENGTH OVERALL	16,2 m / 53'
WATER LINE LENGTH	14,83 m / 48'65"
BEAM	4,95 m / 16'30"
DRAFT	1,25 m / 4'1"
APPROX. LIGHT DISPLACEMENT	19.200 kg / 42,330 lbs
APPROX. LOAD DISPLACEMENT	23.000 kg / 50,700 lbs
FUEL CAPACITY	2.000 L / 528 US gal
WATER CAPACITY	550 L / 145 US gal
ENGINES	2 x Volvo Penta D6-IPS650 353 kW / 480hp 3800 rpm Optional 2 x Volvo Penta D8-IPS800 441 kW / 600 hp 3000 rpm
MAX SPEED	28 kn - IPS 650 33 kn - IPS 800
CRUISING SPEED	22 kn - IPS 650 25 kn - IPS 800
CABINS	2 + 1 (optional)
BATHROOMS	2
MAX PERSONS CAPACITY	12
DESIGN	Brunello Acampora / Victory Design Solaris Power Design Team

60

COMING IN 2024

LONG, COMFORTABLE AND SAFE CRUISING
IN ANY SEA CONDITION, EXCLUSIVE LUXURY
AND ENJOYMENT AT ANCHOR

C
O
U
P
É

60



LONG, COMFORTABLE AND SAFE CRUISING IN ANY SEA CONDITION

The boat sails smoothly through the waves and the deck stays dry thanks to the deep V hull, optimal balance of weights, low centre of gravity and the 60' waterline length. The full walkaround guarantees easy and safe movement from bow to stern even under sail. All of this makes the new 60 Open a real "queen of the sea" with a top speed of 40 knots.

EXCLUSIVE LUXURY AND ENJOYMENT AT ANCHOR

Thanks to the large tender garage for an hydro-jet and water toys, the lift platform for jet-skis, the hydraulic gangway that turns into a comfortable swim ladder and the relax areas on the foredeck and astern.

ALL THE COMFORTS FOR AN ONBOARD ENVIABLE QUALITY OF LIFE

ROOMY INTERIORS FOR LUXURIOUS LIVING DURING EXTENDED STAYS ONBOARD

Full-beam master cabin, optional 3 or 4 cabins with adjoining bathrooms with showers. Independent crew accommodation.

C O U P É





MAIN DECK



LOWER DECK

Version A (standard)



LOWER DECK

Version B (optional)



LOWER DECK

Version C (optional)



60 COUPÉ

TECHNICAL SPECIFICATIONS

LENGTH OVERALL	18,29 m / 60'
WATER LINE LENGTH	16,23 m / 53'24"
BEAM	5,35 m / 17'55"
DRAFT	0,85 m / 2'7"
APPROX. LIGHT DISPLACEMENT	23.000 kg / 50,706 lbs
APPROX. LOAD DISPLACEMENT	26.500 kg / 58,422 lbs
FUEL CAPACITY	3.000 L / 792 US gal
WATER CAPACITY	600 L / 159 US gal
ENGINES	2 x Volvo Penta D6 IPS 800 441 kW / 600 hp 3000 rpm Optional 2 x Volvo Penta D6 IPS 950 533 kW / 725 hp 2500 rpm 2 x Volvo Penta D13 IPS 1350 735 kW / 1000 hp 2400 rpm
MAX SPEED	30 kn - IPS 800 34 kn - IPS 950 39 kn - IPS 1350
CRUISING SPEED	25 kn - IPS 800 28 kn - IPS 950 30 kn - IPS 1350
CABINS	2 / 3
BATHROOMS	2
MAX PERSONS CAPACITY	12
DESIGN	Brunello Acampora / Victory Design Solaris Power Design Team

48

SOLARIS POWER 48 FLYBRIDGE

THE VERSATILITY OF THE FLYBRIDGE
COMBINED WITH THE MARINE
PERFORMANCES OF THE SOLARIS POWER
LOBSTER.

F
L
Y
B
R
I
D
G
E

48







48



MAIN DECK



LOWER DECK

Version A



LOWER DECK

Version B

48 FLYBRIDGE

TECHNICAL SPECIFICATIONS

LENGTH OVERALL	14,86 m / 48'74"
WATER LINE LENGTH	13,40 m / 43'95"
BEAM	4,87 m / 15'97"
DRAFT	1,05 m / 3'44"
APPROX. LIGHT DISPLACEMENT	14.750 kg / 32,518 lbs
APPROX. LOAD DISPLACEMENT	17.550 kg / 38,691 lbs
FUEL CAPACITY	1.500 L / 396 US gal
WATER CAPACITY	430 L / 114 US gal
ENGINES	2 x Volvo Penta D6 IPS 600 320 kW / 435 hp 3500 rpm 2 x Volvo Penta D6 IPS 650 353 kW / 480 hp 3800 rpm
MAX SPEED	27 kn - IPS 600 / 31 kn - IPS 650
CRUISING SPEED	20 kn - IPS 600 / 24 kn - IPS 650
CABINS	1/2
BATHROOMS	1 + 1
MAX PERSONS CAPACITY	12
DESIGN	Brunello Acampora / Victory Design Cav. Norberto Ferretti Solaris Power Design Team

SOLARISPOWER HEADQUARTER

Via Antonio Masetti, 30 - Forlì (FC) - Italy
T. +39 0543 807062 - info@solarispower.com
www.solarispower.com

AGENTS AND DISTRIBUTORS

PLEASE VISIT: WWW.SOLARISPOWER.COM/CONTACTS

DISCLAIMER AND COPYRIGHTS

Solaris Power Yachts reserves the right to change descriptions, modify, or substitute products in this catalogue without notice. Solaris is a registered trademark of Solaris

Yachts Srl, other names may be registered trademarks of their respective owners. Solaris Power © 2024. All rights reserved.

Rendering and illustrations: Victory Design
Photo: C. Borlenghi, A. Muscatello,
M. Paradisi, J. Kelagopian, A. Guerrieri
Graphic design: DL&A Agency

