

MARQUIS™ 720 *Valentina Zannier*

PRELIMINARY



Design and styling: Nuvolari Lenard Naval Architecture, Venice, Italy
Interior Design: Nuvolari-Lenard's Valentina Zannier
Crafted by Marquis Yachts USA

NUVOLARI  LENARD™
Naval Architects Venice, Italy

SPECIFICATIONS

LOA (with swim platform and gunnel molding)	72' 1"	22 m
Molded Hull Length (with gunnel molding)	67' 7"	20,6 m
Beam (with gunnel molding)	18' 4"	5,5 m
Draft (with MTU 10V 2000 engines)	4' 11"	1,5 m
Weight (with fuel, water & MTU 10V 2000 engines)	60 tons	54,4 tonnes
Bridge Clearance (with arch)	23' 9"	7,2 m
Fuel System	1,300 U.S. gals.	4921 liters
Water System	200 U.S. gals.	757 liters
Holding System	153 U.S. gals.	580 liters
Cabin Headroom	6' 8"	2,0 m



MARQUIS™
YACHTS

PRELIMINARY

CONSTRUCTION

- ◇ Cabinetry - marine-type with doweled & dove-tailed joints, metallic joint reinforcements, stainless steel & silicon bronze fasteners, custom fit
- ◇ Open grained, select oak hardwood bulkheads, cabinetry & mouldings throughout cabin
- ◇ Cored hull sides - fiberglass encapsulating high-density foam core below the waterline & endgrain balsa core above the waterline
- ◇ Deck plate - 1.75" (4,4 cm) tubular aluminum rails & 1.75" (4,4 cm) endgrain balsa core encapsulated in fiberglass; mechanically fastened & laminated to hull sides around entire circumference; comprises fore deck, side decks & cockpit sole, & main cabin under-sole
- ◇ Hull bottom - solid fiberglass with Knytex substrates; sandblasted in preparation for bottom paint assures adherence and eliminates the "peeling effect"; vinylester barrier coat
- ◇ Steering shelves (2) - 0.5" (1,2 cm) aluminum plates
- ◇ Stringer system - molded fiberglass grid on hull sides & bottom, high-density foam core
- ◇ Structural engine mountings - linear span, longitudinal rail system with multiple-gusseted steel plates bolted through reinforced, high-density foam-cored stringer members
- ◇ Superstructure - unitized flybridge & deck house construction, self-supporting, aluminum truss cage system configured as monocoque structure, welded to base frame of aluminum bar stock, mechanically fastened to main cabin upper-sole (1.75" (4,4 cm) tubular aluminum rails & 1.75" (4,4 cm) endgrain balsa core encapsulated in fiberglass), assembly bolted to deck plate through drilled-&-tapped reverse flange mount reinforced with aluminum bar stock
- ◇ U.S. Navy-style construction with hull & deck plate forming integrated structural element; "boxed-beam" reinforcement with minimum 1" (2,5 cm) thick structural bulkheads triple-bonded on their circumference
- ◇ Window systems - frameless; tinted, tempered safety glass flange-mounted with urethane adhesive/sealant; supported by aluminum truss system

WATER & HOLDING SYSTEMS

- ◇ Central grey water drain system
- ◇ Fixtures - imported custom taps/spigots
- ◇ Fresh water storage tank (1) - 200 gallons (757 liters), stainless steel
- ◇ Fresh water tank level monitor
- ◇ Grey water sump pump (1) - automatic/manual operation, 3700 gallons (14006 liters) per hour
- ◇ Handshower - fresh water, hot & cold, in transom
- ◇ Grundfos 660 gph (2498 liter/hour) fresh water system - pressurized (110V) (220V), with dual filters and expansion tank
- ◇ Plumbing - flexible lines constructed of molecularly cross-linked polyethylene; rigid lines constructed of PVC
- ◇ Shore water connection with pressure-reduction valve
- ◇ Washdown - fresh water, 1 at bow & 2 at transom
- ◇ Waste holding tanks (2) - (1) 77 gallon (291 liter) & (1) 76 gallon (287 liter), with filtered vents & dockside pumpouts
- ◇ Waste tank level monitors (4)
- ◇ Water heaters (2) - 16 gallons (60 liters) each

ELECTRICAL

- ◇ AC/DC distribution panels with PLC-controlled circuit breakers & integral generator controls; AC digital voltmeters & ammeters, DC digital multimeter
- ◇ Batteries (8) - Douglas, 8D series, marine (12V) cold cranking rating of 1375 amps, reserve capacity of 430 minutes at 25 amp draw, 200 amp/hour rating [(4) engine starting, (4) ship service]
- ◇ Battery (1) - dedicated 31 series Deka Marine®, deep cycle (12V), cold cranking rating of 950 amps, reserve capacity of 225 minutes at 23 amp draw, 100 amp/hour rating [generator]
- ◇ Battery chargers (5) - electronic, AC-DC converters [(2) 75 amp for engine batteries, (1) 25 amp for generator, (1) 100 amp for ship service, (1) 120 amp inverter/charger]
- ◇ Cablemasters - dual
- ◇ Courtesy lights - incandescent
- ◇ Dockside inlet - CATV with 50' (15,2m) of white cord
- ◇ Generator - 32.0 kW 60 Hz (28.0 kW 50 Hz), Kohler® with sound shield, dedicated 31 series battery, 5 year warranty, premium electrical system cablemaster, & remote power source control
- ◇ Ground Fault Circuit Interrupt (GFCI) protection - all electrical outlets
- ◇ Inverter - 4000 watt 12VDC to 110 VAC (24V DC to 220VAC) electrical on select appliances
- ◇ Isolation transformers on the internal shore power lines
- ◇ Overhead lights - 18W (10W), Xenon®, brushed aluminum bezel
- ◇ Shore power connectors (2) - 50 amp (32 amp - 220V)
- ◇ Shore power cords (2) - Marinc® 75' (22,8 m) each, 50 amp (32 amp 220V), white
- ◇ Wiring system - tinned copper strand wire, harnessed, color-coded, labeled, meets or exceeds ABYC standards

BOARDING PLATFORM

- ◇ 107 ft² (9,9 m²) approx., hydraulically-actuated, pantographic, moves out & down, with remote control
- ◇ Boarding ladder - telescoping, with grab rail, concealed beneath platform extension
- ◇ Bilge air exhaust vent - concealed in transom
- ◇ Cockpit stairways (2) - integral to deck
- ◇ Mooring cleats (2) - bollard-style, stainless steel, bolted through aluminum backing plate
- ◇ Grab rails (2) - stainless steel, on transom
- ◇ Teak decking - inlaid, 3/8" (9,5 mm) plank

MARQUIS™ 720 *Valentin Rouvier*

PRELIMINARY

MECHANICAL

- ◇ Air conditioning - Cruisair® split system in cabin, 4-zone, 80,000 BTU; [optional A/C unit on bridge, 24,000 BTU; A/C unit in optional crew quarters, 5,000 BTU]; with reverse cycle heat & heater strips; dedicated Maringo® shore power connector
- ◇ Cutlass bearings - synthetic rubber composite
- ◇ Dripless shaft logs with spare seals on shaft
- ◇ Exhaust mufflers - Generator, Hyro Lift Water Separating
- ◇ Fresh water cooling - engines & Generator
- ◇ Fuel tanks (2) - 650 gallons (2460 liters) each, welded, baffled 5052 aluminum
- ◇ Hull portlights - 10" x 21" (25 cm x 53 cm), screened, multiple latches
- ◇ Marquis Docking System™ includes 13 hp, 9.8" (25 cm) diameter Side Power® bow & stern thrusters providing 507 lbs. (230 kg) of thrust with wireless docking remote control
- ◇ Power steering/Electro Hydraulic
- ◇ Propellers - 5-blade, Certifiable Alloy NiBrAl, 38" (97 cm) diameter, manufacturer-certified
- ◇ Propeller shafts - Aquamet®, 22 Hi Strength 3.5" (9 cm) diameter
- ◇ Rudders & struts, primary & secondary - 421 manganese bronze
- ◇ Seawater strainers
- ◇ Ship's systems control panels in engine room
- ◇ Tides Marine® SureSeal Shaft Seals - self-aligning Nitrile lip seal, maintenance free, spare lip seal included
- ◇ Trim tabs (4) - stainless steel, (4) Actuators

ENGINE ROOM

- ◇ AC & DC distribution panels
 - ◇ Bilges coated with white, medium-gloss gelcoat
 - ◇ Bulkheads laminated to hull side & hull bottom stringers
 - ◇ Catwalk - polished diamond plate
 - ◇ Cockpit hatch access ladder - stainless steel, nonskid steps
 - ◇ Electrical outlet
 - ◇ Entrance hatches (2) - dual access (cockpit & storage lazarette/optional crew quarters)
 - ◇ Insulation - SoundDown®; perforated marine-grade 5052 aluminum surface with polyester-epoxy hybrid powder coat face & nonwoven acoustic material backing; sublayers of 1" (2,5 cm) fire-retardant foam with metalized mylar vapor barrier face, 2-lb./ft² (9,7 kg/m) vinyl acoustic barrier, 1" (2,5 cm) fire-retardant foam
 - ◇ Lights (5) - overhead, fluorescent, controls in cockpit & storage lazarette/optional crew quarters
 - ◇ Surface panels - aluminum, perforated, white
- Mechanical Compartment**
- ◇ Access door - in lazarette storage/optional crew quarters
 - ◇ Bilges coated with white, medium-gloss gelcoat
 - ◇ Bulkhead laminated to hull sides & stringers
 - ◇ Catwalk - polished diamond plate
 - ◇ Light - overhead, fluorescent, controls in cockpit & storage lazarette/optional crew quarters

DECKS

- ◇ Anchor plate - polished stainless steel, with stainless steel clad recessed anchor channel & nylon rollers
- ◇ Beverage holder recess
- ◇ Bow rail - 1.25" (3 cm) O.D., lineal-buffed, 316 stainless steel
- ◇ Bow rail stanchions - double-welded (inside & outside), 316 stainless steel, anchored to aluminum backing plates laminated into bulwark
- ◇ Bulwark - fiberglass
- ◇ Drain grates (2) - polished stainless steel, with insignia
- ◇ Engine room air vents - concealed in superstructure
- ◇ Gutters (2) - port & starboard, direct water from canted walk surface to grated trap, then overboard
- ◇ Hawse pipes (2) - polished stainless steel, port & starboard
- ◇ Lights (6) - 18W Xenon®, minispot-lights, illuminate cabin & bridge sides
- ◇ Lights - accent, courtesy, recessed
- ◇ Lights (6) - overhead, recessed
- ◇ Fore Locker - Contains optional Forward TV, & Shore Power Connectors; fresh & optional raw water washdowns; polished stainless steel hardware; gull-wing door supported by gas shocks; in superstructure forepeak
- ◇ Locker - contains windlass & bollard-style anchor cleat, polished stainless steel hardware, in-deck, self-draining
- ◇ Lockers (2) - fender & line, polished stainless steel hardware, in-deck, self-draining
- ◇ Lockers (2) - fender & line, polished stainless steel hardware, in superstructure, gull-wing doors supported by gas shocks, self-draining
- ◇ Mooring cleats (2) - bollard-style, stainless steel, bolted through aluminum backing plate, inboard-mounted
- ◇ Pilothouse door - manual
- ◇ Rub rail molding - high-impact, heavy duty, 1" (2,5 cm) 316L stainless steel insert
- ◇ Side deck access doors - port & starboard
- ◇ Spring cleats (4) - bollard-style, stainless steel, bolted through aluminum backing plate
- ◇ Sunpad - double
- ◇ Windshield weather covers - black mesh

PRELIMINARY

SAFETY & NAVIGATION

- ◇ 65-5-5-5 marine grade bronze seacocks for all underwater thru-hulls
- ◇ Anodes - zinc, sacrificial
- ◇ Battery master disconnect switches
- ◇ Battery boxes & covers with restraint straps
- ◇ Bilge alarm - highwater
- ◇ Bilge blowers - 250 cubic foot/minute (7 cubic meters/minute) with acoustic filters (1) 24V 4600 cubic foot/minute (130 cubic meters/minute)
- ◇ Bilge pumps (9) - 3700 gallons per hour (14000 liters per hour) each, automatic/manual operation (24V)
- ◇ CO detectors throughout cabin & in optional crew quarters
- ◇ Compass - Ritchie® Navigator 4,5" (11,4 cm), flush mount, illuminated, dual-read
- ◇ Docking lights - transom
- ◇ Engine alarms - all vital possibilities
- ◇ Fire suppression system - automatic, FE241
- ◇ Flagstuffs (2) - bow and stern
- ◇ Fuel alarm lights (2) - indicate water in fuel
- ◇ Galvanic isolator/zinc saver
- ◇ Horns - dual air trumpet
- ◇ Internal bonding system with size 8 gauge wire
- ◇ Molded nonskid surfaces on all walk decks - diamond pattern
- ◇ Navigation lights (COLREGS)
- ◇ Spotlight - ACR 100D, dual light
- ◇ Windlass package - Maxwell® 4000 with 75 lb. (34 kg) stainless steel plow anchor & 300' (91,4 m) of 3/8" (9,5 mm) grade 40 chain
- ◇ High engine exhaust temperature alarm

COCKPIT

- ◇ 114 ft² (10,5 m²) approx., fully guttered & self-draining
- ◇ Bridge stairway - integral, 10" (25 cm) risers (meets residential standards), with stainless steel hand rails, inlaid 3/8" (9,5 mm) plank teak decking steps, 3 recessed courtesy lights
- ◇ Electrical outlet
- ◇ Emergency fire suppression system controls - in starboard transom corner locker
- ◇ Engine room hatch - guttered, watertight, polished stainless steel hardware, supported by gas shocks
- ◇ Fairleads (2) - polished stainless steel, port & starboard
- ◇ Fire extinguisher - in starboard transom corner locker
- ◇ Lights (4) - courtesy, recessed, with exterior-mounted switch
- ◇ Lights (9) - overhead, recessed, with exterior-mounted switch
- ◇ Lockers (2) - storage, in transom corners
- ◇ Lockers (2) - fresh & optional raw water washdown in each, hand-shower in starboard, self-draining, in port & starboard bulwark
- ◇ Lounge - ultraleather upholstery, accommodates 6 adults, across transom, with cover
- ◇ Mooring cleats (2) - bollard-style, stainless steel, bolted through aluminum backing plate, inboard-mounted
- ◇ Overhead sun/weather protection - with mirrored bussola inset
- ◇ Stereo speakers (2)
- ◇ Teak decking - inlaid, 3/8" (9,5 mm) plank
- ◇ Transom gates (2) - stainless steel, Marquis™ monogrammed, at the top of the cockpit stairways

COMMAND BRIDGE

- ◇ Aft bridge extension, self-draining, with toe rail
- ◇ Bar - curved, translucent solid surface countertop with underlighting, stainless steel foot rail, cabinet beneath with bottle holders
- ◇ Beverage holders (8) - stainless steel, self-draining
- ◇ Cabinet - fiberglass, starboard side
- ◇ DC distribution panel - bridge 12V systems
- ◇ Electrical outlets
- ◇ Electronics arch - welded premium grade aluminum painted with AWLCRAFT® 2000 acrylic urethane topcoat for use in harsh marine environments
- ◇ Electronics arch access plates (7) - corrosion-resistant polymer attached with noncorroding fasteners & waterproof sealant
- ◇ Entrance door - stainless steel frame with tinted tempered glass, interior & exterior grab handles & latch handles, keyed deadbolt, weather-tight, provides access to cabin
- ◇ Lights (2) - courtesy, recessed
- ◇ Lights (5) - courtesy, recessed, with exterior-mounted switch
- ◇ Lights - in electronics arch, recessed, with exterior-mounted switch
- ◇ Lights - accent, courtesy, recessed under bar
- ◇ Lounge - command bridge, U-shaped, ultraleather upholstery, accommodates 8 adults, with storage beneath
- ◇ Safety rail - 1.2" (3,1 cm) O.D., lineal-buffed, 316 stainless steel, with intermediate rail, around cockpit stairway opening
- ◇ Safety rail stanchions - double-welded (*inside & outside*), 316 stainless steel, anchored to aluminum backing plates laminated into deck
- ◇ Self-draining walk surface
- ◇ Stereo speakers (2) - in electronics arch, pre-wired
- ◇ Table - fiberglass top, highly polished stainless steel, dual pedestal base
- ◇ Wet bar - solid surface countertop, undermounted sink with cold water faucet, 2 storage cabinets beneath

HELM

- ◇ Air vents (3) - 2 directable, 1 fixed
- ◇ Access doors (3) - provide access to systems & wiring below helm
- ◇ Access panel - provides access to wiring below helm
- ◇ Accessory space - for installing navigation electronics
- ◇ Adapter - 12V
- ◇ Beverage holders (3) - stainless steel, self-draining
- ◇ Companion helm seats (2) - swivel pedestal, high-quality elegant upholstery, embroidery stitching, and arm rests
- ◇ Dash - wraparound fiberglass with brushed aluminum accents
- ◇ Displays (1 for each engine) - digital LCD; engine instrumentation and diagnostics
- ◇ Emergency controls - shift & throttle
- ◇ Gauges - analog; rudder angle, fuel level (1 for each tank)
- ◇ Helm seat - swivel pedestal, high-quality elegant upholstery, embroidery stitching, arm rests, flip-up seat bolster, adjustable height, stitched Marquis™ Yachts icon
- ◇ Lights (2) - courtesy, recessed
- ◇ Rocker-type panel switches
- ◇ Stereo speakers (2) - pre-wired
- ◇ Tilt steering wheel
- ◇ Windshield - tinted, wraparound, stainless steel frame
- ◇ Venturi air deflector

MARQUIS™ 720 *Valentino Zanussi*

PRELIMINARY

GALLEY & ENTERTAINING AREA

- ◇ Coffeemaker (110V only) - Cuisinart®, stainless steel, recessed, on access tray
- ◇ Countertops - granite
- ◇ Designer décor - consisting of premium wall coverings & fabrics
- ◇ Electrical outlets
- ◇ Flooring - granite in galley
- ◇ Hardware highlights - polished stainless steel
- ◇ Lights - overhead, recessed
- ◇ Lights - recessed in bottom of overhead cabinets
- ◇ Microwave/convection oven/broiler - Sharp®, built-in, brushed stainless steel finish
- ◇ Range - full size with oven and 4-burner cooktop
- ◇ Range hood - brushed stainless steel, with 2 lights, exhaust fan, outside vent
- ◇ Refrigerator/freezer - Jenn-Air®, full-size french door, bottom freezer, brushed stainless steel finish
- ◇ Rocker light switches
- ◇ Skylounge Dining Area - with ultraleather lounge, high-gloss wood table accommodating 8 adults
- ◇ Serving bar on starboard side with sink and storage
- ◇ Sink - two basin, stainless steel, undermounted
- ◇ Storage cabinets
- ◇ Storage drawers

SALON

- ◇ AC & DC distribution panels - concealed, hinged
- ◇ Calia Italia® handmade Italian white leather furniture set with sofa and four chairs
- ◇ Cabinets (5) - open grained, select oak hardwood
- ◇ Curtain - décor-matched, slides horizontally in top & bottom tracks, over entrance door
- ◇ Designer décor - consisting of premium wall coverings & fabrics
- ◇ Electrical outlets
- ◇ Entertainment group - 42" (106 cm) Sole® LCD TV (built to durable marine grade standards) with electric lift, enclosed in cabinet, Sony® progressive scan 5-disc DVD/CD changer, Sony® 5.1 channel home theater receiver, Niles In-Wall® theater speakers, subwoofer Sirius® satellite radio system with 6 month trial subscription & Apple iPod® dock
- ◇ Entrance door - stainless steel frame, fully vertical, convex, sliding, handle latch, keyed deadbolt, secures open, neutral density glass with mirrored exterior, interior sliding screen
- ◇ Hardware highlights - stainless steel, polished & brushed
- ◇ Handlaid Brazilian Cherry wood plank flooring
- ◇ Light - metal sconce with linear architectural detail and bold cubic shade, by Cantalupi® of Viareggio, Italy
- ◇ Lights (6) - in soffit, recessed, with electronic dimmer control
- ◇ Lights (10) - overhead, recessed, with electronic dimmer control
- ◇ Overhead architectural feature - stylized oak hardwood
- ◇ Rialto crystal coffee table by Forma & Design®; European contemporary design with enduring style
- ◇ Rocker light switches
- ◇ Soffits (2) - select oak hardwood, port & starboard outboard
- ◇ Bridge interior companionway access - circular, polished stainless steel post & step supports, etched glass steps
- ◇ Window treatment - roman shades with recessed headrails

MASTER STATEROOM

- ◇ Berth - "California King," pillowtop inner-spring mattress, island, with ultraleather upholstered headboard & bolsters around berth
- ◇ Berth nightstands (2) - cabinet beneath
- ◇ Bulkhead architectural feature - upholstered horizontal panels, with accent lighting behind each panel
- ◇ Cabinets (2) - open-grained select oak hardwood, marble sole accent
- ◇ Carpet - premium Ralph Lauren® Winslow Linen
- ◇ Designer décor - consisting of premium wall coverings & fabrics
- ◇ Dresser - 4 drawers, open grained, select oak hardwood
- ◇ Electrical outlets
- ◇ Entrance door - select oak hardwood, secures open & closed, stainless steel hardware
- ◇ Lights (3) - over entry dais, recessed, with electronic dimmer controls
- ◇ Lights (10) - in overhead architectural feature, with electronic dimmer controls
- ◇ Lights (3) - in soffit over berth head, recessed, with electronic dimmer control
- ◇ Lights (3) - in starboard soffit, recessed, with electronic dimmer control
- ◇ Lights (3) - over entry dais cabinet, recessed
- ◇ Lights (3) - over bulkhead architectural feature, recessed
- ◇ Lights (2) - sconce, by Cantalupi® of Viareggio, Italy
- ◇ Lights - accent, recessed under berth & cabinets
- ◇ Mirror - beveled edges, above entry dais cabinet
- ◇ Overhead architectural feature - wood with Nuvolari-Lenard inlay design
- ◇ Rocker light switches
- ◇ Sheet set embroidered iwth Marquis™ logo - fitted sheet, flat sheet, two pillow cases
- ◇ Sofa - ultraleather upholstery
- ◇ Soffit - oak wood grille, around stateroom perimeter
- ◇ Windows (6)
- ◇ Window treatments - roman shades with recessed headrails

Walk-In Closets (2)

- ◇ Carpet - premium Ralph Lauren® Winslow Linen
- ◇ Drawers (2) - recessed
- ◇ Entrance doors - solid oak wood, stainless steel magnetic door catches
- ◇ Hull portlight - with screen
- ◇ Lights - overhead, recessed, automatic operation
- ◇ Shoe storage rack
- ◇ Storage cabinet - recessed

PRELIMINARY

MASTER HEAD

- ◇ Cabinet - open grained select oak hardwood with sea rail
 - ◇ Designer décor - consisting of premium wall coverings & fabrics
 - ◇ Electrical outlets
 - ◇ Entrance door - solid oak wood, secures open & closed, stainless steel hardware
 - ◇ Exhaust fan
 - ◇ Flooring - Spanish Emperador marble
 - ◇ Hardware highlights - stainless steel, polished & brushed
 - ◇ Hull portlight - frosted privacy glass with screen
 - ◇ Lights (2) - overhead, recessed
 - ◇ Lights (7) - over & next to vanity mirror, recessed
 - ◇ Medicine cabinet - 4 shelves with sea rails
 - ◇ Mirror - over vanity
 - ◇ Rocker light switches
 - ◇ Soffit - open-grained select oak hardwood grille
 - ◇ Toilet - Tecma® Silence, full-size, electric pump flush
 - ◇ Toilet paper holder - wall-mounted
 - ◇ Towel bars (2)
 - ◇ Towel sets (2) - bath towel, hand towel, washcloth
 - ◇ Vanity - marble countertop & backsplash, his & hers over-counter basin sinks with bold rectangular shape; custom-mounted, 2 cabinets beneath with sea rails
 - ◇ Wall covering - silk/cotton blend
- Walk-In Tile Shower**
 - ◇ Lights - overhead, recessed
 - ◇ Shower door - frameless glass with stainless steel hardware
 - ◇ Spanish Emperador marble tile walls and flooring
 - ◇ Imported contemporary stainless steel fixtures with detachable shower head for use as handshower
 - ◇ Marble tile bench seat

DUAL MASTER HEAD (OPTION)

- ◇ Designer décor - consisting of premium wall coverings & fabrics
 - ◇ Flooring - marble
 - ◇ Hardware highlights - stainless steel, polished & brushed
 - ◇ Rocker light switches
 - ◇ Towel sets (2) - bath towel, hand towel, washcloth
- His Compartment**
 - ◇ Cabinet - with sea rail
 - ◇ Electrical outlet
 - ◇ Entrance door - solid oak wood, secures open & closed, stainless steel hardware
 - ◇ Exhaust fan
 - ◇ Hull portlight - frosted privacy glass with screen
 - ◇ Lights (2) - overhead, recessed
 - ◇ Lights (5) - over & next to vanity mirror, recessed
 - ◇ Medicine cabinet - 4 shelves with sea rails
 - ◇ Mirror
 - ◇ Soap dispenser
 - ◇ Soffit - open grained select oak grille
 - ◇ Toilet - Tecma® Silence, full-size, electric pump flush
 - ◇ Toilet paper holder - wall-mounted
 - ◇ Towel bars (2)
 - ◇ Vanity - marble countertop & backsplash, over-counter basin sink with bold rectangular shape; custom-mounted, cabinet beneath with sea rail
 - ◇ Wall covering - silk/cotton blend
- Hers Compartment**
 - ◇ Cabinet - oak wood with sea rail
 - ◇ Electrical outlets
 - ◇ Entrance door - solid oak wood,, secures open & closed, stainless steel hardware
 - ◇ Exhaust fan
 - ◇ Hull portlight - frosted privacy glass with screen
 - ◇ Lights (2) - overhead, recessed
 - ◇ Lights (2) - over vanity, recessed
 - ◇ Lights (5) - over & next to make-up vanity mirror, recessed
 - ◇ Make-up vanity - marble countertop, grab rail across front, drawer beneath, wooden stool
 - ◇ Medicine cabinet - 4 shelves with sea rails
 - ◇ Mirror
 - ◇ Soffit - oak wood grille
 - ◇ Toilet - Tecma® Silence, full-size, electric pump flush
 - ◇ Toilet paper holder - wall-mounted
 - ◇ Towel bars (2)
 - ◇ Vanity - marble countertop & backsplash, over-counter basin sink with bold rectangular shape; custom mounted, cabinet beneath with sea rail
 - ◇ Wall covering - silk/cotton blend
- Walk-In Tile Shower**
 - ◇ Entrance doors (2) - dual access (his & hers compartments) frameless glass
 - ◇ Spanish Emperador marble tile walls and flooring
 - ◇ Imported contemporary stainless steel fixtures with detachable shower head for use as handshower
 - ◇ Marble tile bench seat

MARQUIS™ 720 *Valentino Zucchi*

PRELIMINARY

VIP STATEROOM

- ◇ Berth - queen-size, pillow-top inner-spring mattress, island, with Ultraleather upholstered bolsters around berth
- ◇ Berth nightstands (2) - 3 cabinets beneath
- ◇ Berth step-ups (2) - carpeted
- ◇ Bulkhead architectural feature - upholstered horizontal panels with stainless steel vertical details
- ◇ Carpet - Premium Ralph Lauren® Winslow Linen
- ◇ Designer décor - consisting of premium wall coverings & fabrics
- ◇ Electrical outlets
- ◇ Entrance door - solid oak wood, secures open & closed, stainless steel hardware
- ◇ Hardware highlights - stainless steel, polished & brushed
- ◇ Hull portlights (2) - fixed, non-opening
- ◇ Lights (6) - overhead, recessed
- ◇ Lights (3) - over berth head, recessed
- ◇ Lights - accent, recessed under berth
- ◇ Lights (2) - imported with contemporary design directable for reading
- ◇ Overhead hatch - translucent, lockable, with self-storing fold-down stainless steel egress ladder
- ◇ Rocker light switches
- ◇ Sheet set embroidered with Marquis™ logo - fitted sheet, flat sheet, two pillow cases
- ◇ Soffit - oak wood grille
- ◇ Storage cabinets (6)
- ◇ Storage drawer - extra-large
- ◇ Surround shelves - open-grained select oak hardwood
- ◇ Wall covering - silk/cotton blend
- ◇ Wardrobe lockers (2) - full-height, cedar-lined, carpeted, automatic light, mirrored doors, magnetic door catches
- ◇ Window treatments - roman shades with recessed headrail

FOYER

- ◇ Alcove - open-grained select oak hardwood; halogen, overhead, recessed light
- ◇ Flooring - Italian marble with stylized Spanish Emperador marble inset and trimwork
- ◇ Handrail - stainless steel, on stairway
- ◇ Lights (4) - courtesy, recessed
- ◇ Lights (2) - overhead, recessed
- ◇ Rocker light switches
- ◇ Stairwell trim - oak wood, bolster with ultraleather upholstery
- ◇ Wall covering - silk/cotton blend

VIP HEAD

- ◇ Cabinet - recessed, 5 shelves with sea rails
- ◇ Electrical outlet
- ◇ Entrance door - solid oak wood, secures open & closed, stainless steel hardware
- ◇ Exhaust fan
- ◇ Flooring - granite
- ◇ Hardware highlights - stainless steel, polished & brushed
- ◇ Lights (2) - overhead, recessed
- ◇ Lights (2) - over vanity, recessed
- ◇ Medicine cabinet - mirrored door, 2 shelves with sea rail
- ◇ Mirrored bulkhead - over vanity
- ◇ Rocker light switches
- ◇ Soffit - open-grained select oak hardwood grille, over vanity
- ◇ Toilet - Tecma® Silence, full-size, electric pump flush
- ◇ Toilet paper holder - wall-mounted
- ◇ Towel bars (2)
- ◇ Towel ring
- ◇ Towel set - bath towel, hand towel, washcloth
- ◇ Vanity - marble countertop & backsplash, stainless steel grab rail across front, over-counter basin sink with bold rectangular shape; custom mounted, cabinet beneath with sea rail
- ◇ Wall covering - silk/cotton blend
- Shower Stall**
 - ◇ Bench seat - integral
 - ◇ Hull portlight - frosted privacy glass with screen
 - ◇ Light - overhead, recessed
 - ◇ Nonskid sole
 - ◇ Soap dish
 - ◇ Shower door - clear glass in gasketed polished aluminum frame
 - ◇ Shower head - detachable for use as handshower
 - ◇ Towel bar

MARQUIS™ 720 *Valentino Lamer*

PRELIMINARY

GUEST STATEROOM

- ◇ Berths (2) - twin, inner-spring mattress, with upholstered headboards, side boards, & bulkhead bolsters
- ◇ Berth nightstand - open grained select oak hardwood inlay top and sea rail, drawer beneath
- ◇ Carpet - premium Ralph Lauren® Winslow Linen
- ◇ Designer décor - consisting of premium wall coverings & fabrics
- ◇ Electrical outlet
- ◇ Entrance door - solid oak wood, secures open & closed, stainless steel hardware
- ◇ Hanging locker - full-height, cedar-lined, automatic light
- ◇ Hardware highlights - stainless steel, polished & brushed
- ◇ Hull portlight - with screen
- ◇ Light - sconce, brushed aluminum with shade by Cantalupi® of Viareggio, Italy
- ◇ Lights (6) - overhead, recessed
- ◇ Lights - accent, recessed under berths
- ◇ Overhead storage
- ◇ Private guest head access
- ◇ Rocker light switches
- ◇ Sheet sets embroidered with Marquis™ logo - (2) fitted sheet, flat sheet, pillow case
- ◇ Soffit - oak wood grille
- ◇ Storage - beneath berths
- ◇ Wall covering - silk/cotton blend
- ◇ Window treatment - roman shade with recessed headrail

GUEST HEAD

- ◇ Cabinet - 3 shelves with sea rail
 - ◇ Electrical outlet
 - ◇ Entrance doors (2) - dual access (guest stateroom & foyer), solid oak wood, secure open & closed, stainless steel hardware
 - ◇ Exhaust fan
 - ◇ Flooring - granite
 - ◇ Hardware highlights - stainless steel, polished & brushed
 - ◇ Lights (2) - overhead, recessed
 - ◇ Lights (2) - over vanity, recessed
 - ◇ Medicine cabinet - mirrored door, 2 shelves with sea rail
 - ◇ Mirrored bulkhead - over vanity
 - ◇ Rocker light switch
 - ◇ Soffit - oak wood grille, over vanity
 - ◇ Toilet - Tecma® Silence, full-size, electric pump flush
 - ◇ Toilet paper holder - wall-mounted
 - ◇ Towel bar & ring
 - ◇ Towel set - bath towel, hand towel, washcloth
 - ◇ Vanity - marble countertop & backsplash, stainless steel grab rail across front, over-counter basin sink with bold rectangular shape; custom-mounted, cabinet beneath with sea rail
 - ◇ Wall covering - silk/cotton blend
- Shower Stall**
- ◇ Bench seat - integral
 - ◇ Hull portlight - frosted privacy glass with screen
 - ◇ Light - overhead, recessed
 - ◇ Nonskid sole
 - ◇ Soap dish
 - ◇ Shower door - clear glass in gasketed polished aluminum frame
 - ◇ Shower head - detachable for use as handshower

STERN CABIN/DAY HEAD "CABANA"

- ◇ Air conditioning
- ◇ Access door - to starboard mechanical compartment
- ◇ Berth - twin-sized
- ◇ Electrical outlet
- ◇ Entrance doors (2) dual access (engine room & boarding platform); watertight, engine room door has porthole, keyed deadbolt, triple latch
- ◇ Lights - reading
- ◇ Lights - overhead
- ◇ Storage cabinets - wood with high gloss finish
- ◇ Flooring - inlaid teak wood
- ◇ Vanity - granite style countertop
- ◇ Shower stall with toilet enclosed
- ◇ Exhaust fan
- ◇ Mirrored bulkhead over vanity

DOUBLE BERTH CREW QUARTERS (OPTION)

- ◇ Air conditioning
- ◇ Access door - to starboard mechanical compartment
- ◇ Berth - twin-sized, starboard side
- ◇ Berth - twin-sized, port side, private location
- ◇ Electrical outlet
- ◇ Entrance doors (2) dual access (engine room & boarding platform); watertight, engine room door has porthole, keyed deadbolt, triple latch
- ◇ Lights - reading
- ◇ Lights - overhead
- ◇ Storage cabinets - wood with high gloss finish
- ◇ Flooring - inlaid teak wood
- ◇ Vanity - granite style countertop
- ◇ Shower stall with toilet enclosed
- ◇ Exhaust fan
- ◇ Mirrored bulkhead over vanity

PILOTHOUSE (OPTION)

- ◇ Access doors (2) - provide access to wiring below helm
- ◇ Accessory space - for installing navigation electronics in helm
- ◇ Adapter - 12V, at helm
- ◇ Cabinet - oak wood inlay top with sea rail
- ◇ Carpet - premium Ralph Lauren® Winslow Linen
- ◇ Circuit breakers - for helm controls
- ◇ Electrical outlets
- ◇ Helm - fiberglass with stitched leather accents
- ◇ Helm seat - ultraleather upholstery, 6-way electrically adjustable
- ◇ Light - overhead, recessed, red illumination for night operations
- ◇ Lights (5) - overhead, recessed
- ◇ Lounge - ultraleather upholstery, accommodates 4 adults
- ◇ Steering wheel - brushed aluminum rim & hub, adjustable
- ◇ Rocker light switch
- ◇ Windshield defoggers (3)
- ◇ Windshield wipers (3) - pulse, each with fresh water washer

MARQUIS™ 720 *Valentino Zanussi*

PRELIMINARY

OWNER PREFERENCE ITEMS

PROPULSION:

- ◇ MTU® 10V2000 - 1360 hp*
- ◇ CAT® C32 - 1421 hp
- ◇ MTU® 10V2000 - 1500 hp
- ◇ CAT® C32 - 1676 hp

MECHANICAL:

- ◇ Cockpit control station - engine controls & dual joystick control for Marquis Docking System

ELECTRICAL:

- ◇ Dual forward shorepower connector
- ◇ Forward cablingmaster
- ◇ Auxiliary Generator - Kohler® 23 kW 60 Hz (20 kW 50 Hz)

WATER & HOLDING SYSTEMS:

- ◇ Overboard discharge system
- ◇ Water Maker

Transom & Bow Washdowns

- ◇ Fresh water only*
- ◇ Seawater only
- ◇ Both fresh & seawater

SAFETY & NAVIGATION:

- ◇ Autopilot - Raymarine® ST8002 SportPilot w/wireless remote control
- ◇ European style lower helm
- ◇ Pilothouse lower helm
- ◇ Lower helm chair upgrade
- ◇ SeaKey® - satellite based boat security, safety & concierge system; 90 day trial subscription (U.S. & Canada only)

Dual Cockpit Capstan Winches

- ◇ VC 500 - 24v
- ◇ VC 1500 - 24v

Navigation Electronics Package

Plus Radar

- ◇ 12" (30 cm) E-Series Bridge Package - Raymarine® E-Series E120 12" (30 cm) multifunction navigation displays (2), Raymarine® 240 VHF (hand set), 125 WASS GPS sensor, Raymarine® DSM 300 digital sonar module, Raymarine® E66056 bronze thru-hull transducer, and 4KW scanner open array
- ◇ 12" (30 cm) E-Series Bridge & Lower Helm Package - Includes above bridge package plus (2) Raymarine® E-Series E120 12" (30 cm) multifunction navigation displays and Raymarine® 240 VHF (hand set)

- ◇ 12" (30 cm) G-Series Bridge Package - Includes the same equipment as bridge package above with Raymarine® G-Series 12" (30 cm) multifunction navigation display in lieu of E-Series

Video Monitor System

- ◇ Bridge - Voyager®, 1 monitor & 2 cameras
- ◇ Pilothouse - Voyager®, 1 monitor & 2 cameras
- ◇ Bridge & pilothouse - Voyager®, 2 monitors & 2 cameras

Windlass

- ◇ Maxwell® 4000VMC - low profile package*
- ◇ Maxwell® 4000VMC - low profile package with capstan

AMENITIES:

Bridge - Wet Bar

- ◇ Storage*
- ◇ Icemaker - Raritan®, produces up to 22 lbs. (10 kg) of ice a day
- ◇ Refrigerator - Nova Kool®, 3.6 cubic foot (102 liters)
- ◇ Gaggenau® electric aluminum BBQ grill on aft deck (double or single grills)

Canvas

- ◇ Bimini top
- ◇ Bimini top with hard side enclosure

Hardtop Enclosure

- ◇ Soft side enclosure
- ◇ EZ2CY sides with opening windows

Exterior

- ◇ Aft bridge sunpad with stainless steel rails
- ◇ Bridge air cooling
- ◇ Bridge lounge slip covers & pillows
- ◇ Cockpit table - teak wood with protective cover
- ◇ Cockpit to bridge hatch
- ◇ Low profile bridge hard top
- ◇ Helm and seat covers
- ◇ Exterior carpet
- ◇ Painted hull - Navy Blue
- ◇ Passarelle
- ◇ Stereo - waterproof Clarion® D5 AM/FM/CD player, Clarion® 6-disc CD changer, & Apple iPod® dock
- ◇ Underwater lighting
- ◇ Wood inlay bridge table (in lieu of fiberglass table)

Pilothouse Door (must select one)

- ◇ Manual*
- ◇ Electric

Galley Layout

- ◇ Gourmet galley with serving bar*
- ◇ Galley with formal dining table

Serving Bar

- ◇ Storage*
- ◇ Wine cooler
- ◇ Drawer-style refrigerator & freezer

Galley

- ◇ Marquis™ Exclusive China, monogrammed, service for 6
- ◇ Marquis™ Exclusive Crystal glasses, monogrammed, service for 6 (mineral water glasses, wine glasses & champagne flutes)
- ◇ Marquis™ Exclusive Crystal double old fashioned glasses (set of 8) and decanter
- ◇ Marquis™ Exclusive Flatware, monogrammed, service for 6
- ◇ Dishwasher - Miele® Slimline, stainless steel, built-in, holds 9 place settings, Energy Star® appliance
- ◇ Trash compactor - GE®, stainless steel (110 V only)

Salon

- ◇ Satellite TV system

STATEROOMS

Master Stateroom

- ◇ Safe
- ◇ Washer & dryer in walk-in closet (not available with Fourth Stateroom) - Malber®, front loading & energy efficient
- ◇ Washer & dryer in aft port hanging locker (only available with Fourth Stateroom) - Malber®, front loading & energy efficient
- ◇ 32" (81 cm) TV (built to durable marine grade standards) & Clarion® DVD/CD/MP3 player
- ◇ His & hers master head compartments (N/A with fourth stateroom)

Master Stateroom Stereo

- ◇ Stereo - Clarion® AM/FM/CD marine stereo & Apple iPod® dock
- ◇ Stereo with surround sound - Bose Lifestyle® 38 Home Entertaining System

Master Stateroom Storage

- ◇ Settee & dresser*
- ◇ Double dresser

VIP Stateroom

- ◇ 19" (48 cm) LCD TV (built to durable marine grade standards) & Clarion® DVD/CD/MP3 player
- ◇ Stereo - Clarion® AM/FM/CD & Apple iPod® dock

Third Stateroom

- ◇ 15" (38 cm) LCD TV (built to durable marine grade standards) & Clarion® DVD/CD/MP3 player
- ◇ Stereo - Clarion® AM/FM/CD marine stereo & Apple iPod® dock

Optional Fourth Stateroom

- (not available with His & Her Master Heads)*
- ◇ 15" (38 cm) LCD TV (built to durable marine grade standards) & Clarion® DVD/CD/MP3 player
- ◇ Stereo & Apple iPod® dock

Lower Companionway

- ◇ Beam® Central Vacuum System - outlet in lower companionway and Salon

Stern Cabin

- ◇ Stern Cabin/Day Head "Cabana"*
- ◇ Double berth crew quarters with accommodations
- ◇ Crew Entertainment Package with 15" (38cm) TV, DVD & stereo (single or double crew entertainment packages available)
- ◇ Washer/dryer - Malber®, front loading & energy efficient combomatic

MARQUIS™ 720 *Valentino Zannier*

PRELIMINARY

OWNER PREFERENCE ITEMS

VALENTINA ZANNIER DESIGNER CONTEMPORARY INTERIOR DECOR BY NUVOLARI-LENARD:

An exquisitely fresh interior design creates a contemporary European yacht environment with select oak cabinetry, hand-laid Brazilian cherry salon flooring, handmade Italian leather salon furniture and an enduringly stylish crystal coffee table.

Fabric Ensemble

- ◇ Golden Shores* (brown tones with flecks of gold)
- ◇ Biscotti (dark chocolate browns and ivory)
- ◇ Distinguished premium selection of custom fabrics by Bergamo® and Rubelli® of Italy. Leading designer and importer of the finest upholstery and drapery fabrics

Granite Countertops

- ◇ Giallo*
- ◇ English Brown
- ◇ Black Galaxy
- ◇ Autumn Brown

OPTIONAL TRADITIONAL INTERIOR DÉCOR:

Formal elegance with select cherry or nutmeg hardwood cabinetry, invitingly comfortable ultraleather salon furniture and Ralph Lauren® premium carpet create an impressive, traditional-style yacht environment.

Interior Wood Species

- ◇ Jewel gloss Cherry Wood
- ◇ Jewel gloss Nutmeg Wood

Fabric Ensemble

- ◇ Golden Shores* (brown tones with flecks of gold)
- ◇ Biscotti (dark chocolate browns and ivory)
- ◇ Distinguished premium selection of custom fabrics by Bergamo® and Rubelli® of Italy. Leading designer and importer of the finest upholstery and drapery fabrics

Granite Countertops

- ◇ Giallo*
- ◇ English Brown
- ◇ Black Galaxy

INTERNATIONAL SPECIFICATIONS:

- ◇ Electrical systems in 220V
- ◇ Entertainment equipment (televisions & stereos) not available in Japan
- ◇ Sirius Satellite radio only available in U.S. & Canada
- ◇ Some electrical equipment is only offered in 120V/60Hz; check with your Marquis Dealer for availability outside the U.S.

MARQUIS™ 720 *Valérie Lamer*

PRELIMINARY

FLOOR PLANS

Fly Bridge

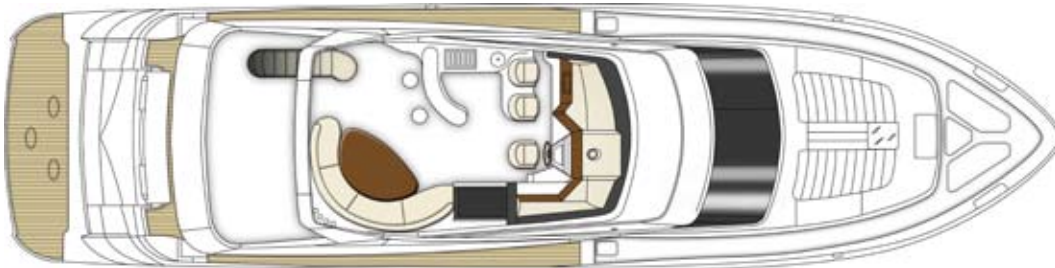

Main Deck



Main Deck with Helm Option and Dining Table



Accommodations Deck



Accommodations Deck
Shown with optional
Fourth Stateroom &
Double Crew Quarters

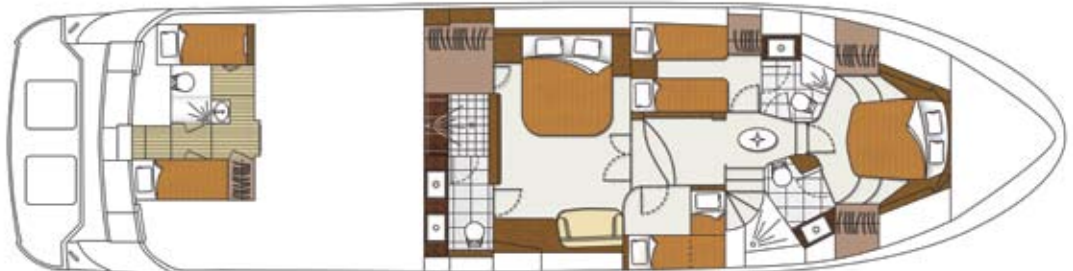

Genmar Yacht Group, LLC

Marquis Yachts Headquarters

Marquis Yachts International

P.O. Box 101 ♦ 790 Markham Drive ♦ Pulaski, WI 54162 ♦ USA
phone: (920) 822-3214 ♦ fax: (920) 822-3213

Le Roc Fleuri ♦ 1, Rue du Ténac ♦ 98000 Monte Carlo ♦ Monaco
phone: +377 (9798) 3202 ♦ fax: +377 (9798) 3203

www.marquisyachts.com